

Feel free to share your photos and videos with us and we might put them on our website.



- Facebook.com/FreevisionVILTA
- Twitter.com/FreeVisionVILTA
- instagram.com/freevision_vilta

VILTA Mobile

User Manual

V1.0

2018.04

Contents

Overview	
Packing List	02
Product Overview	03
Quick Start	
App Installation	04
Smartphone Installation and Balance	05
App Connection	08
Start Up	
Control Panel Introduction	09
App Menu Introduction	14
App Operation	16
Specifications	
Specifications Parameter	19
Technical Parameter	19
Other Specification	20
Warranty Information	22

Packing List

- VILTA Mobile

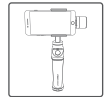

- Portable Bag



- Charging Cable

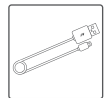

- Lanyard



- User Manual



- Stripe



Product Overview

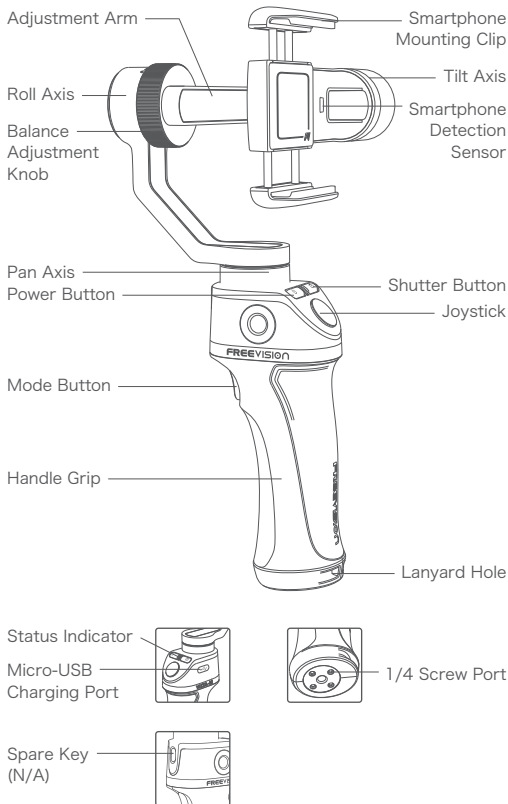

App Installation

- Download App on Freevision's official website www.freevisiontech.com.
- For iOS user, search "FV Share" in App Store.



- For Android user, search "FV Share" in Google Play or scan below QR Code, please select "Vilta for Mobile" and download



- Android 4.3 above or iOS 9.0 above required.

Smartphone Installation & Balance



- VILTA Mobile won't work unless mounting the phone. Smartphone detection can be closed in App.
- Always keep your phone well balanced in level prior to power on, or it will greatly affect working performance.v

01 Smartphone Installation

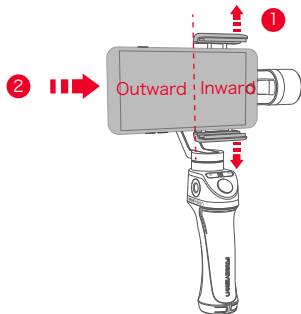

- 1 Pull open the smartphone mounting clip.
- 2 Put your phone in and keep it close to the tilt axis motor.



Please ensure back camera of phone is outward and not covered.

02 Smartphone Balance

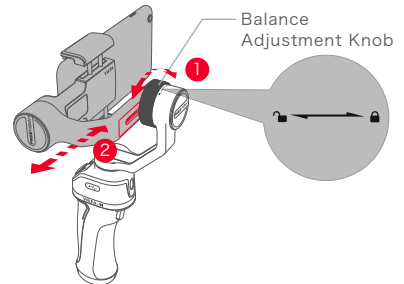

- 1 Unscrew the balance adjustment knob
- 2 Slightly move the adjustment arm

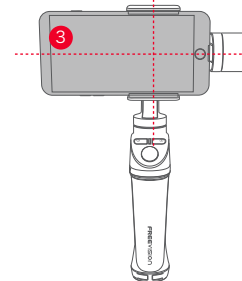

- 3 When your phone can stay level and balanced, screw up the balance adjustment knob.



Write scale of adjustment arm for easy reuse.

03 Power On/Off

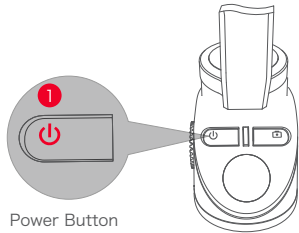

1. Long press power button for 3 seconds to power on/off.
2. Single tap power button to bring in/out of sleep mode.
3. Triple tap power button to enter POV mode. The current scene mode will be prompted in the main interface.

 If system halted, long press power button for 7.5 seconds to mandatory shutdown.

App Connection

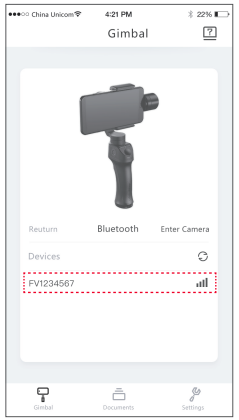
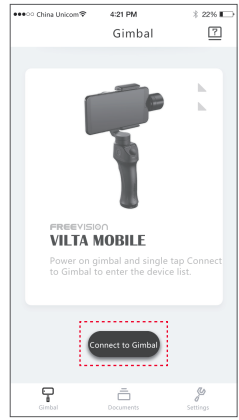

- Turn on bluetooth and unlock the phone screen rotation. Ensure phone can be displayed horizontally.
- Open App, tap Connect to enter the device list. Choose your gimbal to connect.
- The light of shutter button will go out after successfully connected.

Control Panel Instruction

01 Shutter Button

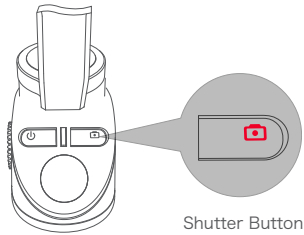

Single Tap	Photo Mode	Take Photo
Double Tap	Selfie Mode	Front & Back Camera Switch
Long Press for 2s	Video Mode	Recording On/Off

02 Status Indicator

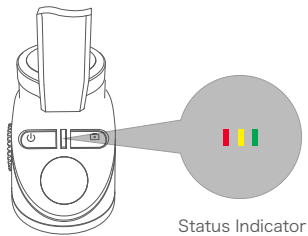

Red light glints	Warning (Abnormal Condition)
Green light glints	Busy/Auto Calibration

! Abnormal conditions of VILTA Mobile include absence of phone, motor damage, internal fault, etc.

03 Mode Button

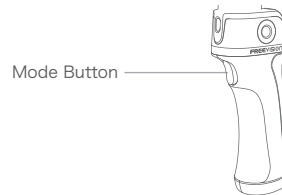

- Semi-follow Mode (default)
 - Single tap Mode Button
 - Status Indicator is yellow
 - Tilt and Roll Axes are locked.
 - Pan Axis smoothly moves with handle

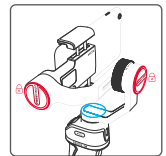

■ Follow Mode

Double tap Mode Button
Status Indicator is red

Roll Axis is locked. Pan and Tilt Axes smoothly move with handle

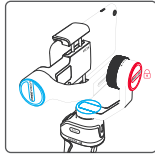

■ POV Mode

Triple tap Power Button
Status Indicator is flashing yellow

None of Tilt, Roll and Pan Axes are locked. Tilt, Roll and Pan Axes smoothly move with handle

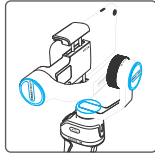

■ Lock Mode

Quadruple tap Mode Button
Status Indicator is green

Tilt, Roll and Pan Axes are locked. Smartphone always keeps the current shooting direction

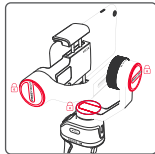

■ Center the smartphone

Triple tap Mode Button

The smartphone returns to the front

■ Focusing

Long press Mode Button



04 Joystick

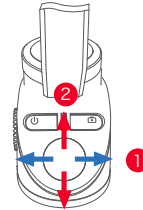

Basic Function

- 1 When toggling joystick to left or right, VILTA Mobile will rotate corresponding level direction.
- 2 When toggling joystick upward or downward, VILTA Mobile will rotate corresponding vertical direction.

💡 Direction of control can be modified in App.

Advanced Function

- Zoom—Long press mode button and toggle joystick upward or downward.
- Exposure—Long press mode button and toggle joystick left or right.
- Roll Axis Angle—Long press mode button and toggle joystick left or right.

💡 Adjustment of exposure and roll axis angle can be switched in App.

05 Micro-USB Charging Port



- When charging, status indicator alternately glints in red, yellow and green.
- When fully charged, the status indicator is green.
- Please apply charging cable with standard configuration to charge VILTA Mobile.
- When the power button glints, please charge VILTA Mobile.

 When the charging current is 2A, it takes 2.0 hours to be fully charged, which allows 17 working hours. Datum come from laboratory test.

■ Phone Charge

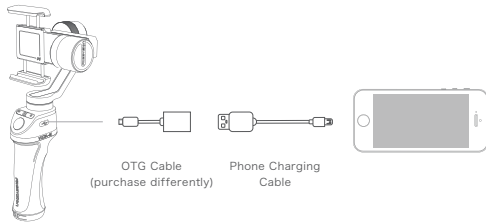

Please use OTG cable and phone charging cable to charge your phone.

06 Manual

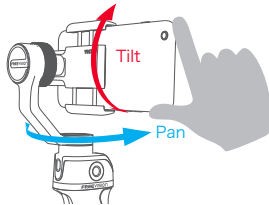

Directly adjust the shooting direction by hand.
Manual mode can be turned off in VILTA Mobile App.

App Menu Introduction

Android users may not be able to use the fully optimized functions of VILTA Mobile.
We thank you for your understanding and support.

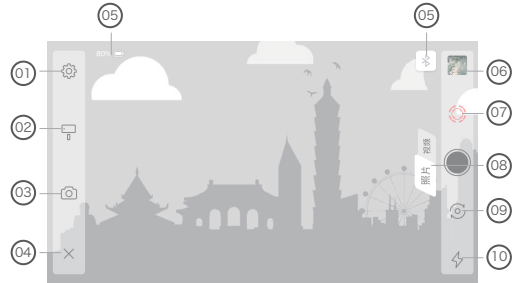

01 General Settings

- Camera
Camera Resolution, Video Resolution, Panorama Quality, Panorama Saved, Photo and Video save address
- Gimbal
Scene Mode Settings, Dead Zone Settings, Mode Button+Toggle Joystick, Phone Detection, Gimbal Calibration, Reset All
- Joystick
Speed, Dead Zone, Direction, Smooth Degree
- Information
Gimbal Battery Information, Gimbal Information, App

02 Gimbal Settings

- Scene Modes:
Walk Mode, Sport Mode, Custom Mode

■ Follow Modes:

Follow Mode, Semi-follow Mode, Lock Mode, POV Mode

■ Gimbal Manual Mode

03 Camera Settings

■ Camera Mode:

Time-lapse, Panorama, Long Exposure, Beauty, HDR, Filter, White Balance, Grid, Camera Manual Mode

■ Video Mode:

Slow Motion, Beauty, Filters, Time Lapse, Motion Time Lapse, Motion Lapse, White Balance, Grid, Camera Manual Mode

04 Return

Tap  to return to App home page



05 Information

Gimbal Battery, Phone Battery, Bluetooth Connection Status

06 Documents

Preview and storage location of photos and videos.

07 IntelliTrace

Tap  to turn on IntelliTrace. Tap  to turn off IntelliTrace. Frame the subject and VILTA Mobile will track in real time.

 Answering a phone when recording or in IntelliTrace, the shooting will be automatically stopped.





08 Photo/Video Switch

Tap  to switch

09 Front/Back Camera Switch

Tap  to switch

10 Flashlight Status

- Display the current flashlight status
- Tap  to switch working state    

App Operation





Photo Mode

01 Panorama



Tap  to enter panorama. Choose 180°, 330°, 3*3, 3*5, VILTA Mobile will automatically shoot and compund panorama. Photo will be automatically saved to documents.

Video Mode

02 IntelliTrace

1. Tap  and choose sport mode in scene mode.
2. Tap  to start IntelliTrace. Frame the subject on your phone screen.
3. Tap  to start recording. VILTA Mobile wil intelligently identify and automatically track the subject to take video.
4. Tap  to exit recording. Tap  to exit IntelliTrace. Video will be automatically saved to documents.

03 Time Lapse

1. Switch to video mode. Tap  and choose time lapse.
2. Set shutter interval and time of duration. Tap Start.
3. Tap  to exit recording. Video will be automatically saved to documents.

04 Motion Time Lapse

1. Switch to video mode. Tap  and choose motion time lapse.
2. Set shooting points

Auto Mode



- Manually adjust phone to ideal shooting point. Take photo at that direction and it will be shown as shooting point A on App. Likewise, the rest shooting points can be done in the same approach.
- According to the shooting points, VILTA Mobile will automatically generate shooting path.
- Adjust smoothness of the shooting path.

Manual Mode



- Freely set the shooting path by directly drawing on your phone screen.
3. Set shutter interval and time of duration. Tap Start.



05 Slow Motion Video

1. Tap  and open Slow Motion.
2. Tap  to start recording. Tap  to exit recording. Videos will be automatically saved to documents.

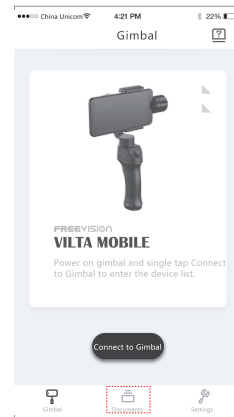

06 Photo/Video Editing



1. Photo Editing

- Enter App home page and tap  on the bottom
- Tap  to choose the photo and editing (Filter, Beautify, Adjust, Mosaic, Crop, Paint)
- Tap  to confirm editing

2. Video Editing

- Enter App home page and tap  on the bottom. Choose Videos
- Tap  to choose the video and editing (Add Video, Video Editing, Add Music, Filter, Adjust)
- Tap  to confirm editing

Specifications Parameter

Name	VILTA Mobile
Item No.	VT10
Dimensions	275*115*40mm (Folded)
Weight	520g
Supported Phones	Phones Width: 48~85mm

Technical Parameter

01 Mechanical Rotation Range

Tilt	±125°
Roll	±90°
Pan	360° (Infinite Rotation)

02 Controllable Rotation Range

Tilt	±115°
Roll	±45°
Pan	360° (Infinite Rotation)

03 Maximum Control Speed

Adaptive Rotation Speed (±500°/s)

04 Accuracy

Static Accuracy	Dynamic Accuracy
Tilt: 0.003°	Tilt: 0.02°
Roll: 0.003°	Roll: 0.02°
Pan: 0.005°	Pan: 0.03°

05 Battery

Battery Type	Intelligent Lithium Battery
Voltage	7.4V
Working Current	Static:100mA Dynamic:5A
Battery Capacity	1900mAH
Energy	14.06WH
Consumption	1W

Other Specification

Operating Temperature	-5°C~40°C
Wifi Type	Bluetooth 4.2

Warning

- Do not expose to fire or high heat
- Drop and collision will break VILTA. Please caution.
- Not water-proof. No water or liquid cleaning agent.
- Do not disassemble, repair or modify VILTA Mobile.
- Please apply charging cable complying with public safety regulation.
- Do not interfere VILTA Mobile operation when working.
- Not suitable for children.
- Not include smartphones.
- When mounting motion cameras, close the smartphone detection in App, or VILTA Mobile will not work.
- The lock button backward will be open in future as it is a reserved button for upgraded function. Now it can't be toggled.

Web: www.freevisiontech.com
Email: support@freevisiontech.com
Tel: +86 4009970100

Warranty Rules

From the purchase date, you enjoy free repair within 12 months with this card if it occurs any quality problems.

If your VILTA Mobile meets the following requirements, you can enjoy the warranty policy:

- If within 7 days of purchase and it occurs manufacturing defect, the customer can choose to have a full refund(based on the invoice price) or exchange the product for a new one;

- Within 1 year of purchase, you can enjoy free repair if it is non man-made problem,
- The Product has not been refitted, disassembled or modified.
- Valid purchase proof is provided

Non Warranty Rules

If your VILTA Mobile falls under one of the following situations, we will charge appropriate maintenance cost:

- A man-made problem affecting the quality or product;
- Damage caused by refitting, disassemble, or opening of the shell;
- An uncontrollable incident (earthquake, fire, flood, war) resulting damage;
- Damage caused by not using as stated in the user manual

Warranty Information

- The customer is at first required to pay the product return delivery fee. After Freevision after-sale service center receives the product, it will undergo a test;
- If the product does not conform to the conditions for free repair, Freevision will assess the problem and cost of repair, the customer has the right to repair or deliver it back.
- When you receive the repair service, please provide valid purchase proof and this warranty card. Please note: the warranty card only becomes valid after sale. The card can not be altered, or it will be deemed invalid.
- Freevision reserves the right of final interpretation.

